

- Tube Fitting (Double Ferrule)-
 Tube To Male Pipe Thread

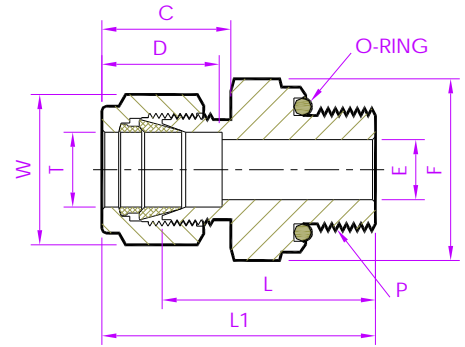

Male Connector

Metric Tube x O-seal ISO Parallel (M)

Tube Part No.	Equivalent Part No. Type 1	Equivalent Part No. Type 2	TUBE OD Ø T	ISO Male Pipe Size P	ØE	D	C	L	L1	Body Hex F	Nut Hex W
			(mm)	(In)	Dimensions in Millimetres						
6M - MCD - 2OIP	-----	M6MSC1/8R - ED	6	1/8	4.8	15.3	17.7	25.1	32.5	14.2	14.2
6M - MCD - 4OIP	-----	M6MSC1/4R - ED		1/4	4.8			30.8	38.2	19.0	
6M - MCD - 6OIP	-----	M6MSC3/8R - ED		3/8	4.8			32.1	39.5	22.2	
6M - MCD - 8OIP	-----	M6MSC1/2R - ED		1/2	4.8			37.1	44.5	27.0	
10M - MCD - 4OIP	-----	M10MSC1/4R - ED	10	1/4	7.9	17.2	19.5	32.4	40.0	19.0	19.0
10M - MCD - 6OIP	-----	M10MSC3/8R - ED		3/8	7.9			33.5	41.1	22.2	
10M - MCD - 8OIP	-----	M10MSC1/2R - ED		1/2	7.9			38.4	46.0	27.0	
12M - MCD - 4OIP	-----	M12MSC1/4R - ED	12	1/4	9.5	22.8	22.0	33.0	43.1	22.2	22.2
12M - MCD - 6OIP	-----	M12MSC3/8R - ED		3/8	9.5			33.5	43.6	22.2	
12M - MCD - 8OIP	-----	M12MSC1/2R - ED		1/2	9.5			38.4	48.5	27.0	

NOTE : 1)The E Dimension is the minimum opening & Fittings of this group may be back drilling to lager ID at pipe thread or straight thread end.
 2)Dimension L1, C, D is shown in the finger-tight position. 3)Dimensions are for reference only and are subject to change 4)ISO (BSP Parallel) thread as per BS 2779.